

# GENERAL ARRANGEMENT - OCEAN MAINTAINER 1

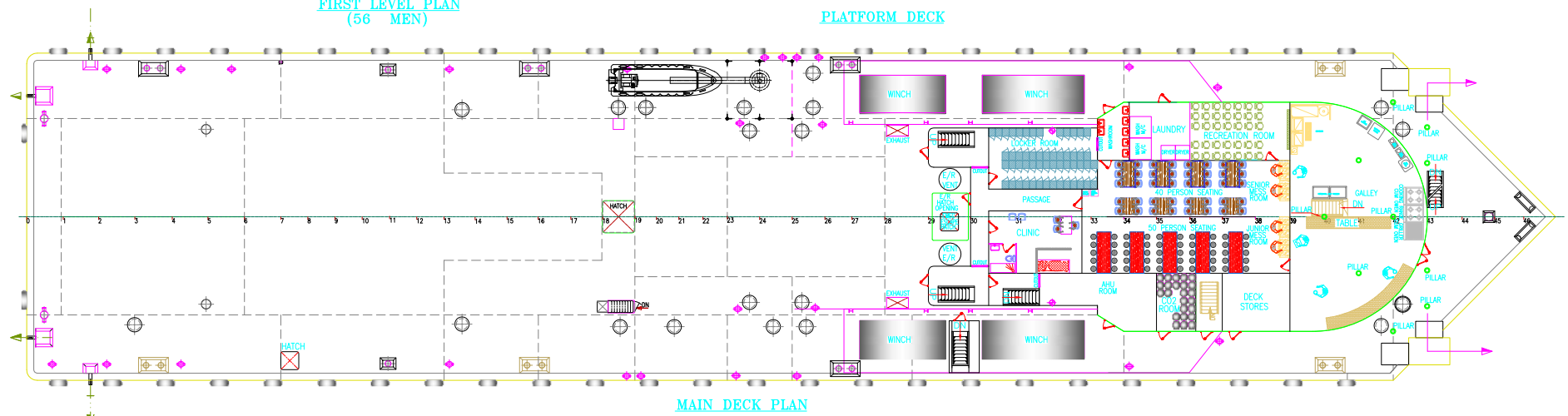
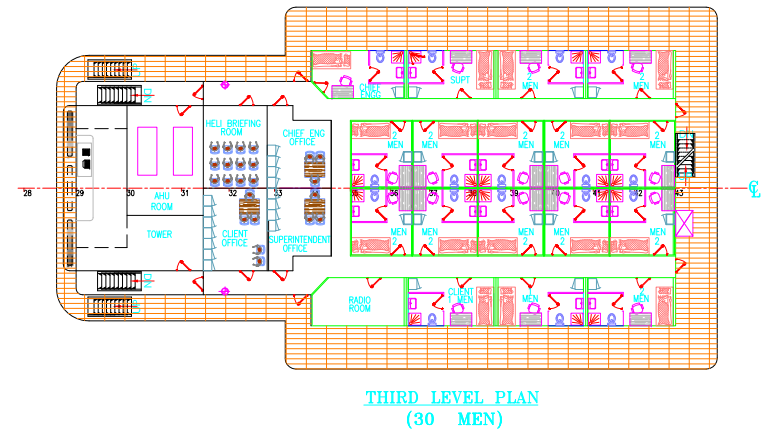
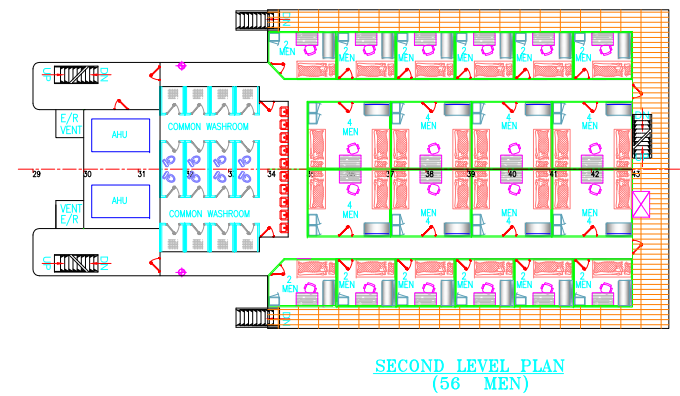
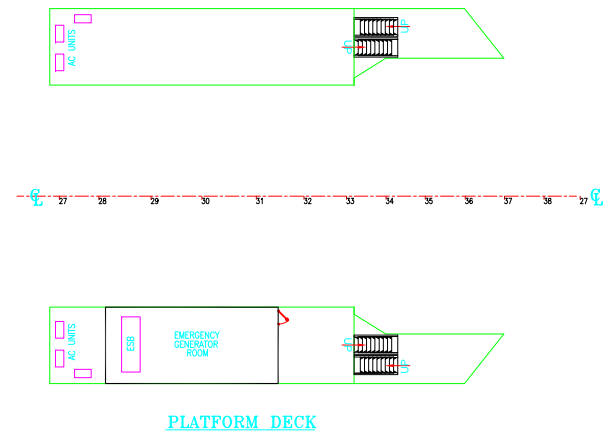
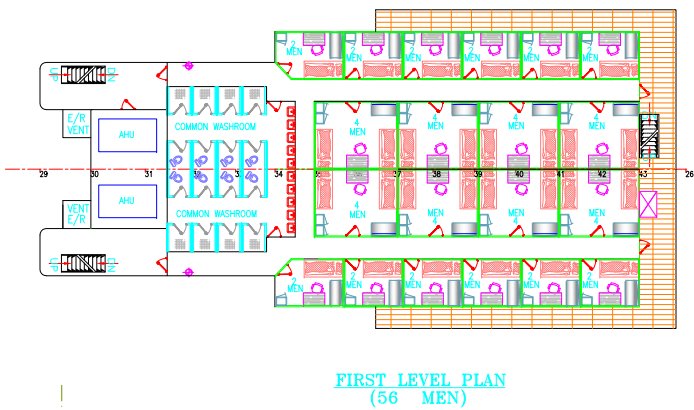
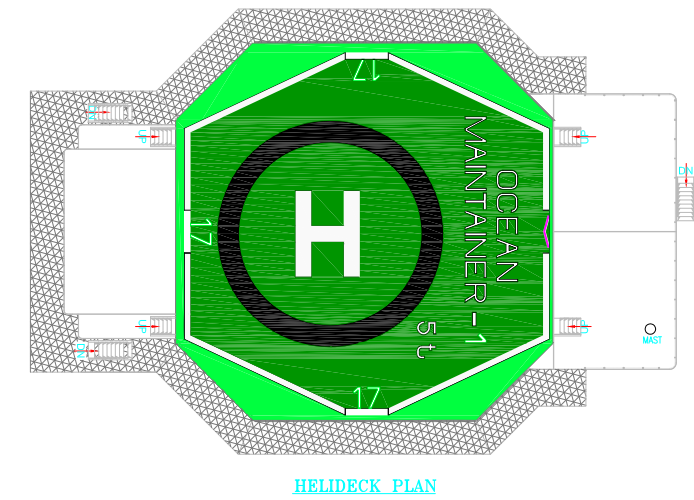
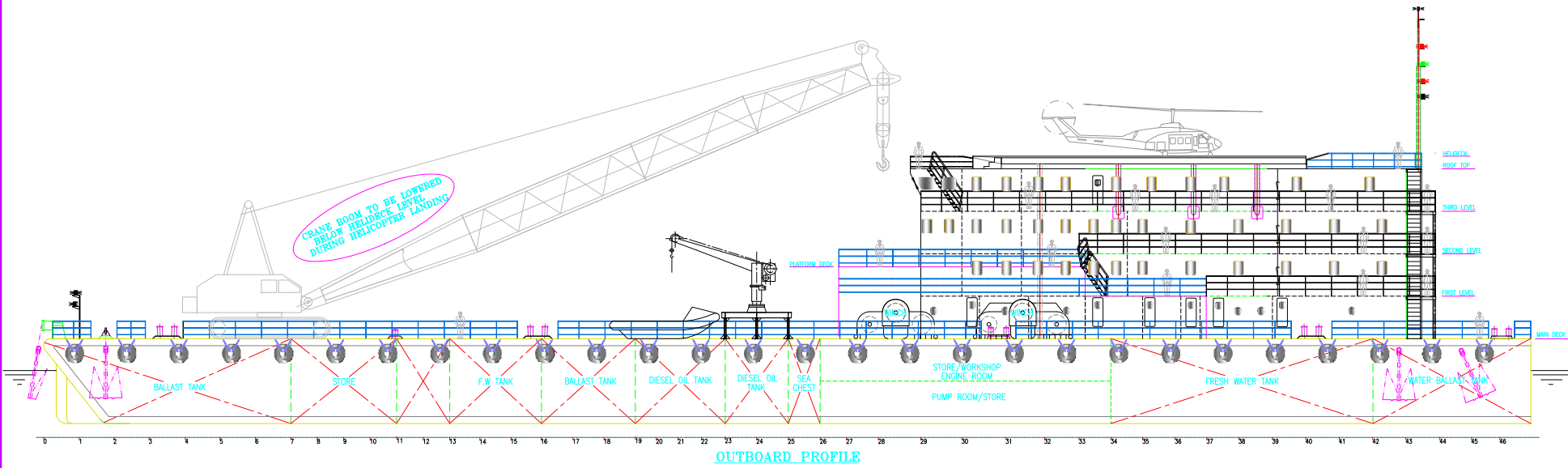

NO. OF SPECIAL PERSONS - 125  
TOTAL NO OF PERSONS - 142

**NOTE:-**  
W.T.D INDICATES WEATHER TIGHT DOOR

**LEGEND:-**  
— INDICATES EXISTING ACCOMMODATION STRUCTURE  
— INDICATES NEW ACCOMMODATION STRUCTURE

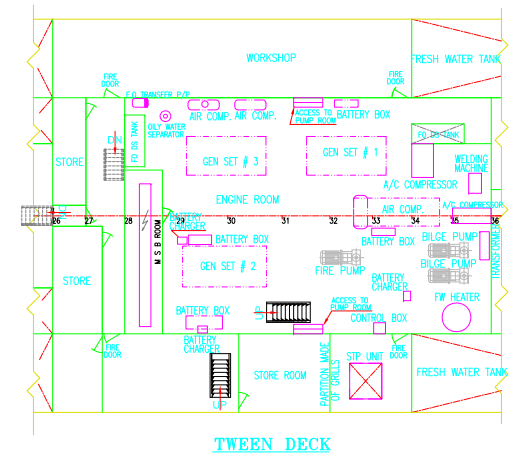
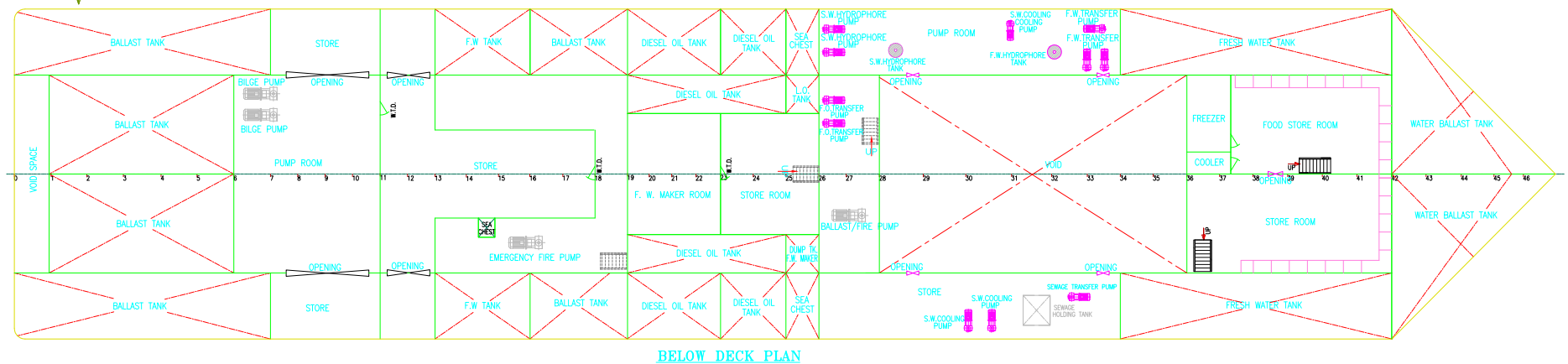

**MAIN PARTICULARS**

LENGTH	= 85.344 M
LBP	= 81.75 M
BREADTH	= 18.288 M
DEPTH	= 4.876 M
DRAFT	= 3.048 M
DATE OF BUILT	= 1966, REBUILT IN 1982
CALL SIGN	= 3ELY
FLAG	= PANAMA
IMO NUMBER	= 8766545

**OCEAN MAINTAINER 1**

REV	DATE	DESCRIPTION	REVISED BY	APPROVED
F	19.07.10	REVISED AS PER DESIGN PROGRESS	SVJ	VSP
E	14.04.10	AHU ROOM INTRODUCED AT 3rd LEVEL	VSP	MPV
D	07.04.10	3rd LEVEL ACCOMMODATION LAYOUT MODIFIED.	VSP	MPV
C	24.02.10	BELOW DECK PLAN UPDATED AS PER DESIGN PROGRES.	VSP	MPV
B	15.01.10	ACCOMMODATION MODIFIED AS PER CLIENTS COMMENT.	VSP	MPV
A	05.01.10	ACCOMMODATION MODIFIED.	NITHI	MPV
D	05.10.09	INITIAL ISSUE	-	GM

**REVISIONS**

**ARIES MARINE & ENGG. SERVICES**  
 P.O. BOX - 24496, SHARJAH, U.A.E.  
 Tel: 00971(0)6 5614166, Fax: 00971(0)6 5614167  
 Website: www.ariesmar.com, Email: design@ariesgroup.ae

This drawing, design concept, and specifications are the property of **ARIES MARINE & ENGG. SERVICES** and are furnished on a confidential basis with an expressed understanding that they will not be copied in any manner, used for manufacture, sold, transferred, nor used to the detriment of said firm without written permission. The recipient further agrees not to disclose these contents hereof to any other parties except for those specific purposes for which this drawing was issued.

**GENERAL ARRANGEMENT**

VESSEL NAME :	OCEAN MAINTAINER 1	DATE :	19.07.10	DWG. No :	DN7338/202
DRAWN BY :	NITHI	JOB No :	DN7338	SHEET :	01 OF 01
CHECKED BY :	VSP	SCALE :	1:175	REV :	F
				SIZE :	A1